

DOMED PLATE FOR FRICTION BOLT



| Product Code Guide | Plate Type | Size | Thickness | Hole Diameter | Coating | Packaging |
|--------------------|------------|------|-----------|---------------|---------|-----------|
| | D | 1515 | 4 | 41 | G | T098 |

Physical Properties

| Length | Width | Thickness | Nett Weight | To suit Friction Bolt Size |
|--------|-------|-----------|-------------|----------------------------|
| mm | mm | mm | kg | mm |
| 120 | 120 | 4 | 0.43 | 33 |
| 150 | 150 | 4 | 0.72 | 33 |
| 150 | 150 | 4 | 0.67 | 39 |
| 150 | 150 | 8 | 1.30 | 47 |

Key Features

- Domed Plates in 4mm are compatible with DSI Underground Friction Bolts.
- Assist in overcoming the problems of minor surface angularity.
- The Domed Plate and Friction Bolt assembly allows for up to 3° of angular misalignment.
- DSI Underground domed plates are designed to indicate when a load being transferred to the plate is approaching the yield strength of the bolt by deforming.
- Most DSI Underground Friction Bolt Domed Plates incorporate a generous lug for hanging of service lines. Note the 120 x 120 to suit 47mm bolts does not include a LUG.
- Corrosion protection may be provided by various OBDURO® coating.

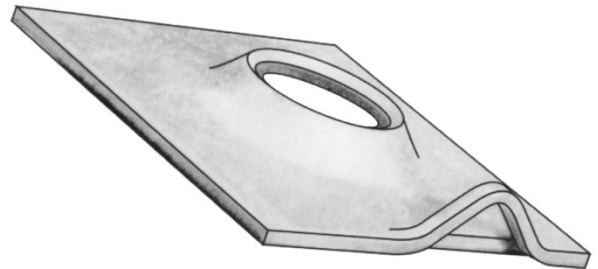

Packaging

- Domed Plates are tied with wire clips and then palletised.

Notes

- DSI Underground is Quality Assured to ISO 9001:2015



DOMED PLATE FOR FRICTION BOLT



Product Accessories Examples

- DSI Underground manufactures a comprehensive range of products specifically designed for this range of plates.

Typically, Products used are:

| | Products | | |
|---------------------|---|---|---|
| Product Group | Butterfly Plate | Pull Ring | Bolts |
| Product Imagery |  |  |  |
| Product Code Prefix | BUTT | PR | FB |

Phone APP

- Want to know more; our full product range, knowledge centre, and other details are available via the App; available on iOS and Android devices by searching “DSI Underground”.



iOS



Android