

Product Code Guide	Bolt Type	Diameter	FB Length	Drive Nut & Accessories	Coating	Packaging
	FBMC	47	240	DPK4	G	

## Physical Properties

	Minimum		Typical	
Yield Strength	600MPa	220kN	650MPa	240kN
Tensile Strength	840MPa	305kN	890MPa	315kN
Elongation (after fracture)	15%		19%	
Mass Per Metre			5.79kg	
Friction Bolt Diameter	Ø47mm			
Hole Diameter Range	Ø43mm min./Ø45.5mm max.			
Cross Sectional Area	370mm <sup>2</sup>			

## Key Features

- The Ø47mm Mechanically Point Anchored Bolt in addition to the standard frictional force, provides a tensionable point anchor by way of an internal solid bolt.
- The KINLOC Bolt uses standard installation procedures, with the addition of tensioning the base nut via rotation of the installation socket spanner in a single pass.
- The total system capacity is in excess of 30 tonne.
- An M24 thread is used to develop the significant additional anchorage capacity.
- Further corrosion protection can be provided by galvanizing.
- Incorporates an Event Capture System (ECS) to retain the bar in the event of bar fracture due bar overload / shear.

## Installation Guidelines

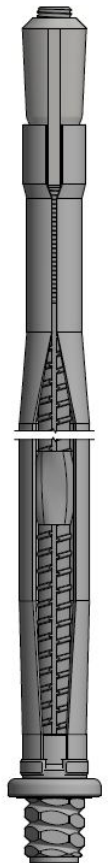

- The hole length should allow additional distance for the point anchoring head on insertion.
- The driving spanner dolly is fitted into the rock drills chuck and then the bolt and plate is placed into the dolly.
- Using full percussion and thrust, the bolt is fully driven into the hole until the domed plate is firmly against the rock surface. The spanner dolly is then rotated left without percussion until stall.
- Recommended minimum rotation force during installation 250 – 400Nm
- DSI Underground does NOT recommend rotational force greater than 400Nm.



## Product Accessories Examples

- DSI Underground manufactures a comprehensive range of plates specifically designed for this range of Bolts.

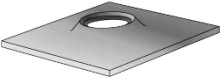
Typically used accessories:

	Products			
Product Group	Spanner	Dome Plates	Mesh Plate	Dragon Fly
Product Imagery				
Product Code Prefix	T38	D	D170MESH	DF

## Standard Length & Packaging

- Standard bolt lengths range from 1,500mm to 3,000mm in 300mm increments.
- Non-standard lengths are available on application.
- KINLOC Bolts are supplied in standard packs of 150 bolts.

## Notes

- Only DSI Underground rock bolt components should be used to enable the optimum performance of the bolt system to be obtained.
- DSI Underground is Quality Assured to ISO 9001:2015

## Phone APP

- Want to know more; our full product range, knowledge centre, and other details are available via the App; available on iOS and Android devices by searching “DSI Underground”.



iOS



Android