

Product Code Guide	Bolt Type	Diameter (mm)	Length (cm)	Drive Nut & Accessories	Coating	Packaging
	FBMC	47	240	DPH4	G	E

## Physical Properties

	Minimum		Typical	
Yield Strength	300MPa	110kN	400MPa	150kN
Tensile Strength	600MPa	220kN	680MPa	250kN
Elongation (after fracture)	14%		20%	
Friction Bolt Diameter	Ø47mm			
Mass Per Meter	6.03kg			
Cross-Sectional Area	370mm <sup>2</sup>			
Hole Diameter Range	Ø44mm min/Ø45.5mm max			
Installation Torque	330Nm nominal			

## Key Features

- The Ø47mm Mechanically Point Anchored Bolt, in addition to the standard frictional force, provides a tensionable point anchor by way of an internal solid bolt.
- The KINLOC Bolt – SE uses standard installation procedures, with the addition of tensioning the base nut via rotation of the installation socket spanner in a single pass.
- The total system capacity exceeds 24 tonnes.
- An M24 thread provides robust anchorage capacity.
- Further corrosion protection can be provided by galvanizing.
- Incorporates an Event Capture System (ECS) to retain the bar in the event of bar fracture due to bar overload/shear.

## Installation Guidelines

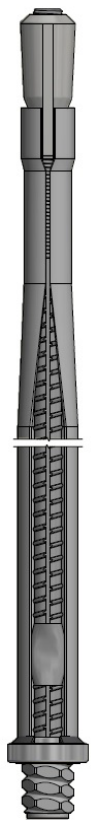

- The hole length should accommodate the full length of the bolt, which includes the expansion head.
- The driving spanner dolly is fitted into the rock drills chuck, and then the bolt and plate are placed into the dolly.
- Using full percussion and thrust with water on, the bolt is fully driven into the hole until the domed plate is firmly against the rock surface. The spanner dolly is then rotated left without percussion until it stalls.
- Recommended torque range during installation 250 – 400Nm.
- DSI Underground does NOT recommend torque greater than 400Nm.



## Product Accessories Examples

- DSI Underground manufactures a comprehensive range of plates specifically designed for this range of Bolts.

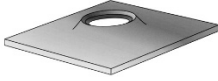
### Typically used accessories:

	Products			
Product Group	Spanner	Dome Plates	Mesh Plate	Dragon Fly
Product Imagery				
Product Code Prefix	T38	D	D170MESH	DF

## Standard Length & Packaging

- Standard bolt lengths are 2,400mm and 3,000mm.
- Non-standard lengths are available on application.
- KINLOC Bolts are supplied in standard packs of 150 bolts.

## Notes

- Only DSI Underground rock bolt components should be used to enable the optimum performance of the bolt system to be obtained.
- DSI Underground is Quality Assured to ISO 9001:2015

## Phone APP

Want to know more; our full product range, knowledge center, and other details are available via the App; available on iOS and Android devices by searching “DSI Underground.”



iOS



Android